

First Solid-State Lithium-ion Battery ESS

RT10854

- Higher Safety Protection
- Faster Dis/Charging Speed
- High Inverter Compatibility
- Intelligent Built-in BMS
- 16pcs Connections in Parallel



FEATURES



6000

Cycle Life@25°C



Solid-State

LFP Battery Cells



10.9kWh

Capacity



0.75C

Discharging Rate



7680W

Peak Power



Increase 8%

Energy Density



The test of drill



The test of shear



The test of acupuncture



The test of squeeze

APPLICATION

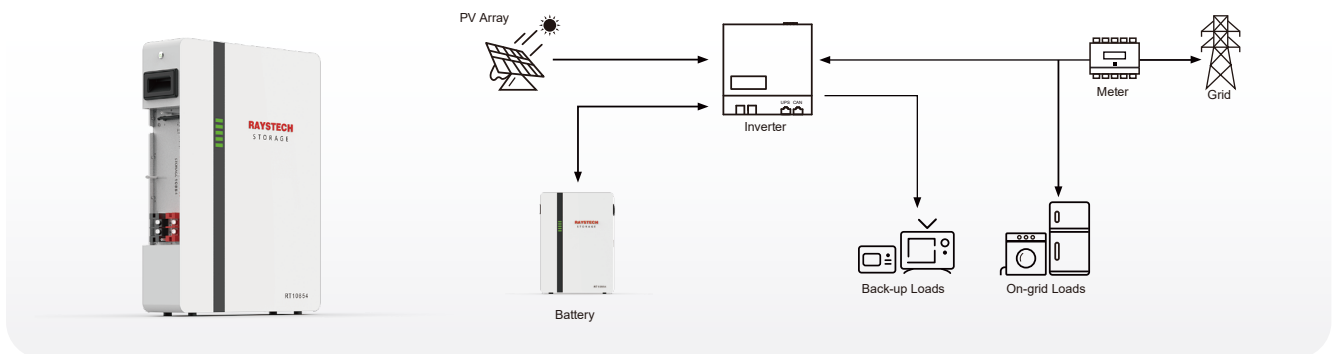

Technical Specifications

Product Type		RT10854
Total Energy*		10.85kWh
Battery Capacity		106Ah+106Ah
Max.recommended DOD		93%
Max Charge Power		6.14kW
Max Discharge Power		7.68kW
Voltage		48~56Vd.c
Nominal Voltage		51.2Vd.c
Nominal Charging Current		100A
Nominal Discharging Current		120A
Max Charging Current		120A
Max Discharging Current		150A(6min.)
Max. Charge Voltage		55.6Vd.c
Weight(N.W.)		89kg
Dimension(mm)(L*W*H)		800*580*165mm
Operating Condition		Indoor
Operating Temperature	Charge	From 0~50 ℃
	Discharge	From -10~55 ℃
Humidity		<90%(No condensed water)
Over Voltage Category		II
Cooling Type		Natural cooling
Installation		Wall mounting/Ground Installation
IP rating		IP 20
Protective Class		I
Max. Connection Number		16P
Communication		CAN/ RS485
Protection Mode		Dual hardware protection
Battery Protection		Over-current/Over-voltage/Short circuit/ Under-voltage/Over temperature
Safety		Cell UL 1973
		CE/TUV
Hazardous Material Classification		9
Transportation		UN 38.3
Product Warranty		10 years warranty, 6000 cycles life

Testing conditions based on temperature 25 ℃ at the beginning of life.

*Total Energy/Usable Energy measured under specific conditions from RAYSTECH 0.5C CC-CV.

Compatibility

DEYE/MEGAREVO/LUXPOWER/Voltronic/Victron/Sofar/Solis/Goodwe/INVT/Thinkpower/TBB/Sermatec/Growatt/Afore/SMA/Solinteg/Sol-ark/AISWEI/EPEVER