

RT-545-560-BMA-HV

RAYSTECH

RAYSTECH  
Monocrystalline Series  
545-560W



Products Characteristics

- Less mismatch to get more power
- Less power loss by minimizing the shading impact
- Competitive low light performance
- 3 times EL test to ensure best quality
- Ideal choice for utility and commercial scale projects by reduced BoS and improved ROI
- Outstanding reliability proven by PVEL for stringent environment condition:
  - Sand, acid, salt, and hail stones
  - 2400 Pa wind load and 5400 Pa snow load
  - Anti-PID

15 YEARS Guarantee on product material and workmanship

25 YEARS Linear power output warranty



Electrical Characteristics

Module Type	RT-545-BMA-HV		RT-550-BMA-HV		RT-555-BMA-HV		RT-560-BMA-HV	
	STC	NOCT	STC	NOCT	STC	NOCT	STC	NOCT
Maximum Power at STC (Pmp)	545	409	550	414	555	418	560	422
Open Circuit Voltage (Voc)	49.60	46.32	49.70	46.40	49.80	46.50	49.90	46.60
Short Circuit Current (Isc)	13.90	11.23	14.00	11.32	14.10	11.41	14.20	11.50
Maximum Power Voltage (Vmp)	41.80	38.41	42.05	38.58	42.31	38.68	42.56	38.78
Maximum Power Current (Imp)	13.04	10.65	13.08	10.73	13.12	10.81	13.16	10.89
Module Efficiency at STC(ηm)	21.10		21.29		21.48		21.67	
Power Tolerance	(0, +4.99)							
Maximum System Voltage	1500V DC							
Maximum Series Fuse Rating	25 A							

STC: Irradiance 1000 W/m<sup>2</sup> module temperature 25°C AM=1.5  
Power measurement tolerance: +/-3%

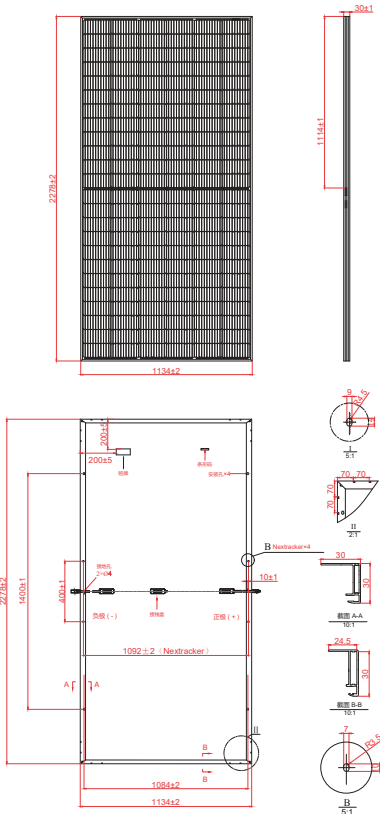

I-V Curve

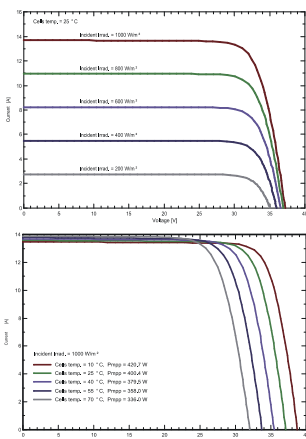

Temperature Characteristics

Pmax Temperature Coefficient	-0.34%/°C
Voc Temperature Coefficient	-0.26%/°C
Isc Temperature Coefficient	+0.05%/°C
Operating Temperature	-40~+85°C
Nominal Operating Cell Temperature (NOCT)	45±2°C

Mechanical Specifications

External Dimensions	2278 x 1134 x 30 mm
Weight	27.0kg
Solar Cells	PERC Mono(144pcs)
Front Glass	3.2 mm AR coating tempered glass, low iron
Frame	Anodized aluminium alloy
Junction Box	IP68, 3 diodes
Output Cable	4mm <sup>2</sup> , 250mm(+)/350mm(-) or Customized Length
Mechanical Load	Front side 5400Pa/ Back side 2400Pa

Packing Configuration

Container	40'HQ
Pieces per Pallet	36
Pallets per Container	20
Pieces per Container	720